

Subwoofer Gadget – Getting Started

1. Power it up

Plug it into a USB port and its red LED will light up to show that it's working. (I assume that the gadget gets the power from a PC USB port).

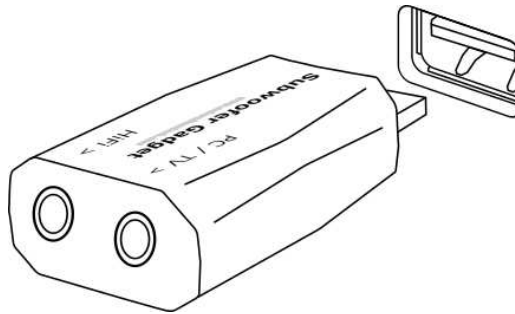

2. Connect it to the audio source

Connect the source such as the audio output of the TV, PC, subwoofer (pre) out, music player, etc. to the 3.5mm socket input with label “PC/TV”.

3. Connect it to your amplifier

Connect the 3.5mm output socket with label “Hi-Fi” to the audio input of the amplifier or active (self-powered) subwoofer.

4. Use the bypass button

Use a screwdriver to push the bypass button. The red LED will dim to show it is in bypass condition/mode. Push it again to toggle it back the normal operation condition/mode.

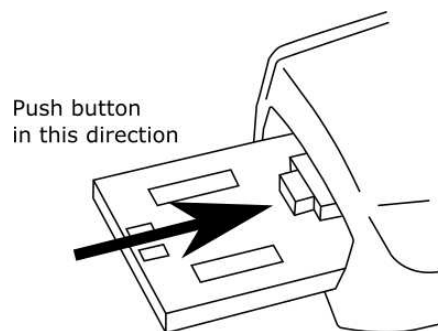

5. Setup the subwoofer volume

Adjust the subwoofer volume to make the volume balance with that of the main speakers. Turn its volume down until you cannot hear it and then turn it up gradually until you can just listen it.

6. Usages and features

Application	Connection to Gadget's		Effects	
	Input	Output	Loud & Deep	Sub. Move-in
Stereo System	Music player	Amp. Aux-in	Yes	N/A
Stereo Headphone	Music player	Headphone	Yes	N/A
Game 2.1 System	PC	Amp. Aux-in	Yes	Yes
Soundbar with Sub.	TV	Amp. Aux-in	Yes	Yes
Home Theater 5.1, 7.1	Amp. Sub out	Active Sub	Yes	N/A
Home Theater 5.2, 7.2	Amp. Sub outs	Active Subs	Yes	N/A

7. Specifications

- CD Quality
- Two independent processing channels

8. Troubleshooting

Problems	Solutions
The red LED does not turn on.	Flip the Gadget and plug it into the USB port again or try another USB port.
Only one channel is working.	Check the 3.5mm jack to see whether it is completely plugged into the socket.
The main speakers' sound is small.	The subwoofer sound is too loud and masks the main speakers. Turn the subwoofer volume down and turn up master volume of the whole audio system. Refer to 5.
I can't hear the Subwoofer Move-in effect	<ol style="list-style-type: none">1. The sound of your subwoofer may be too loud, refer to 5 to re-adjust its volume.2. The main speakers' diaphragm diameter is less than 1.5 inches. Larger diaphragm size is more preferable.

<http://www.naturalbasstech.com>